

# GREATER METRO TRANSIT STUDY – MEETING CURRENT NEEDS

## REINVENT KENNEDY PLAZA

Summer festivals and markets are becoming a regular occurrence in Greater Kennedy Plaza. Check [www.kennedyplaza.org](http://www.kennedyplaza.org) for upcoming events.



Kennedy Plaza can be both a successful transit center and a vibrant urban place. The redesign of Kennedy Plaza will enhance rider experience, improve pedestrian space, and reconnect downtown Providence to the surrounding neighborhoods.

### A VIBRANT GATEWAY TO DOWNTOWN PROVIDENCE

Kennedy Plaza, once seen only as a center for boarding buses, is now undergoing a transformation into much more than a transportation hub. The redesigned Kennedy Plaza, while still the center of the RIPTA system, will become a vibrant, centrally coordinated, gateway to the City of Providence that offers activities, events, and commerce, as well as public transit. First steps include the creation of several new smaller hubs outside of downtown for waiting buses. Also, RIPTA will work with the City to disperse the bus berths around Greater Kennedy Plaza, including throughout Biltmore and Burnside Parks and along a new, two-way Exchange Street. This will help RIPTA and the City, working collaboratively, to improve its public space to better serve pedestrians, transit-riders, and those who live and work down-

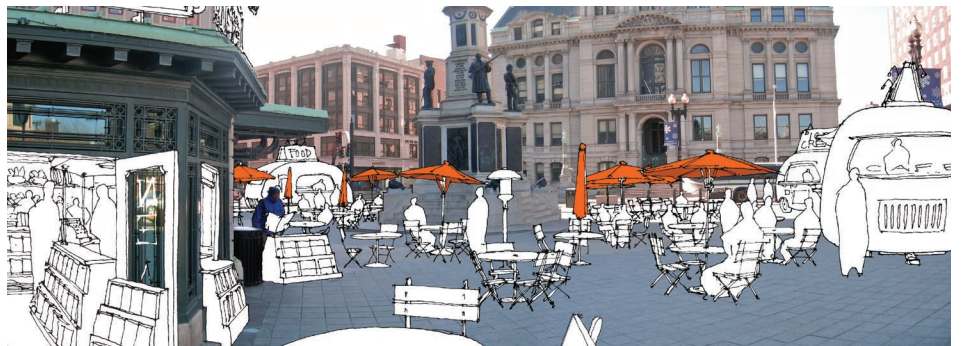



town. Greater Kennedy Plaza will be better connected to the surrounding neighborhoods as well as to the rest of the city, ushering the way for our city's new streetcar system.

In the summer 2009, RIPTA embarked on this mission by hosting a design workshop in partnership with downtown stakeholders, including the City of Providence, downtown property owners, residents, and local businesses. The re-imagined configuration of transit in Greater Kennedy Plaza will enhance the pedestrian experience, improve vehicular flow, invite expanded commercial and cultural activities, provide economic opportunity and enhance the tax base in the center of our state's Capital City.

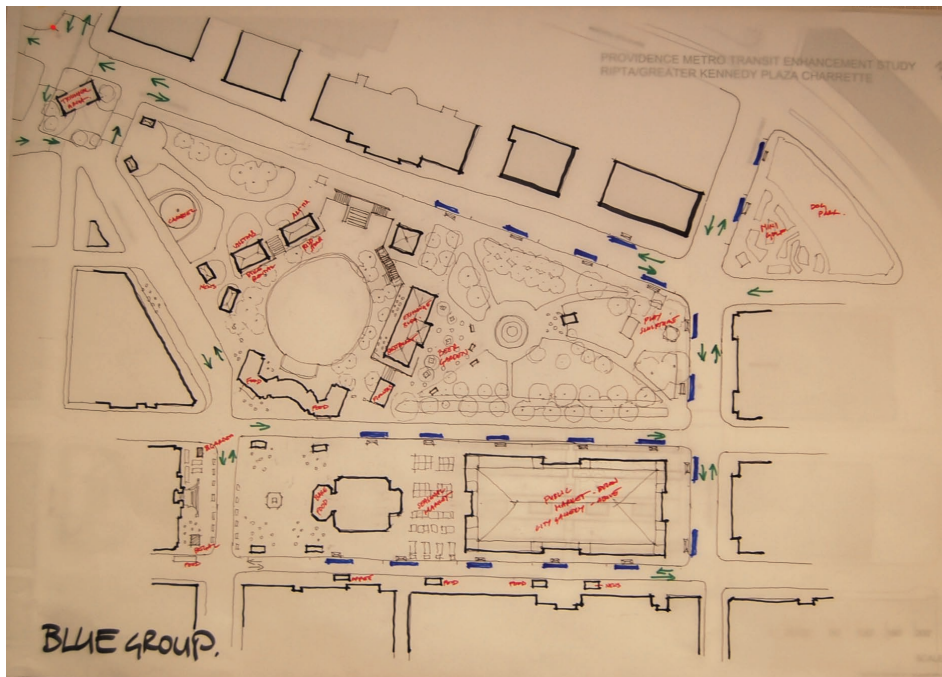

## GREATER KENNEDY PLAZA PLANNING WORKSHOP



Above: participants in the Greater Kennedy Plaza planning workshop.

Left: some of the concepts generated by the GKP workshop.

Rethinking Kennedy Plaza will provide a productive center to RIPTA's system and benefit the experience of downtown Providence.



### Develop Short-term Plan

Develop alternatives to existing bus berths

Develop two new peripheral hubs



### Implement Short-term Plan

Develop two additional peripheral hubs



### Develop long-term Plan

Implement design for unused berth spaces

Develop new bus operations plans



### Design and Development for longer-term options



### Implement long-term enhancements

Construct streetcar accommodations